



# EXTENSION DE TRÉMIE

## AC01393

---

### INSTRUCTIONS D'INSTALLATION

---

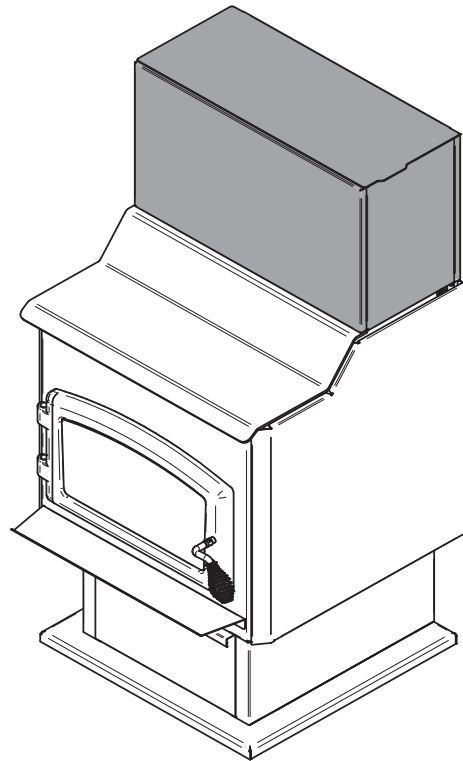
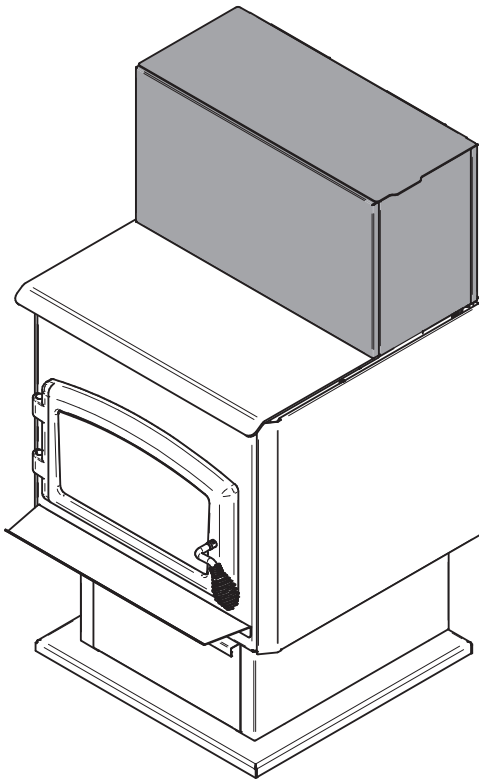

**Fabricant de poêles international inc.**

250, rue de Copenhague, St-Augustin-de-Desmaures  
(Québec) Canada, G3A 2H3

Service aux consommateurs : 1-877-356-6663

Courriel : [tech@sbi-international.com](mailto:tech@sbi-international.com)



Ce manuel peut être téléchargé gratuitement à partir du site Web du fabricant. Il s'agit d'un document dont les droits d'auteur sont protégés. La revente de ce manuel est formellement interdite. Le fabricant se réserve le droit de modifier ce manuel de temps à autre et ne peut être tenu responsable de tous problèmes, blessures ou dommages subis suite à l'utilisation d'information contenue dans tout manuel obtenu de sources non autorisées.

# APPLICATION

Cette extension de trémie permet d'augmenter la capacité de la trémie de 80 lbs.

# DIMENSIONS HORS TOUT

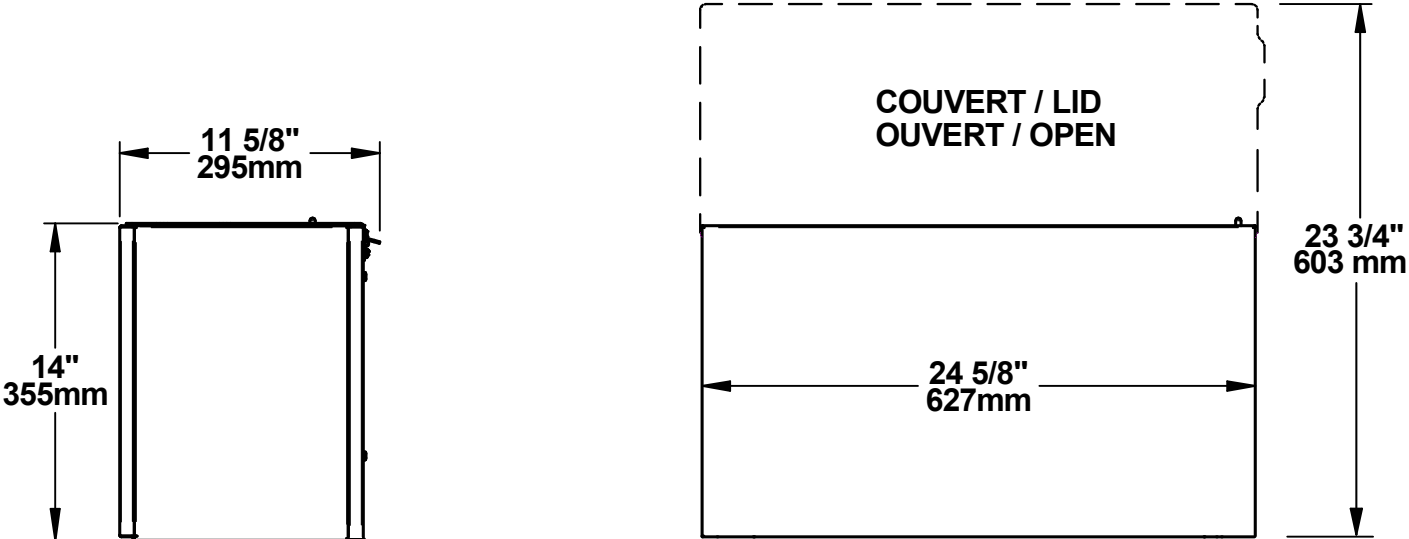

## CONTENU DE L'ENSEMBLE

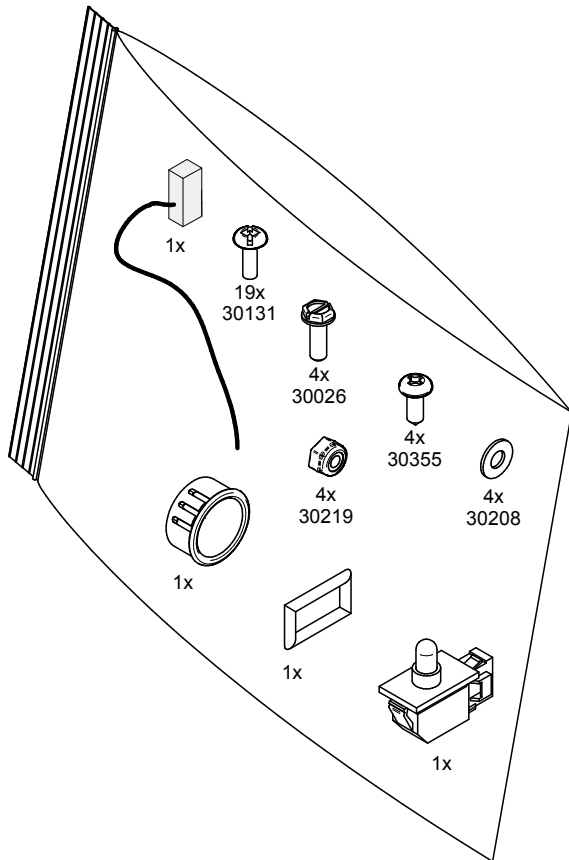
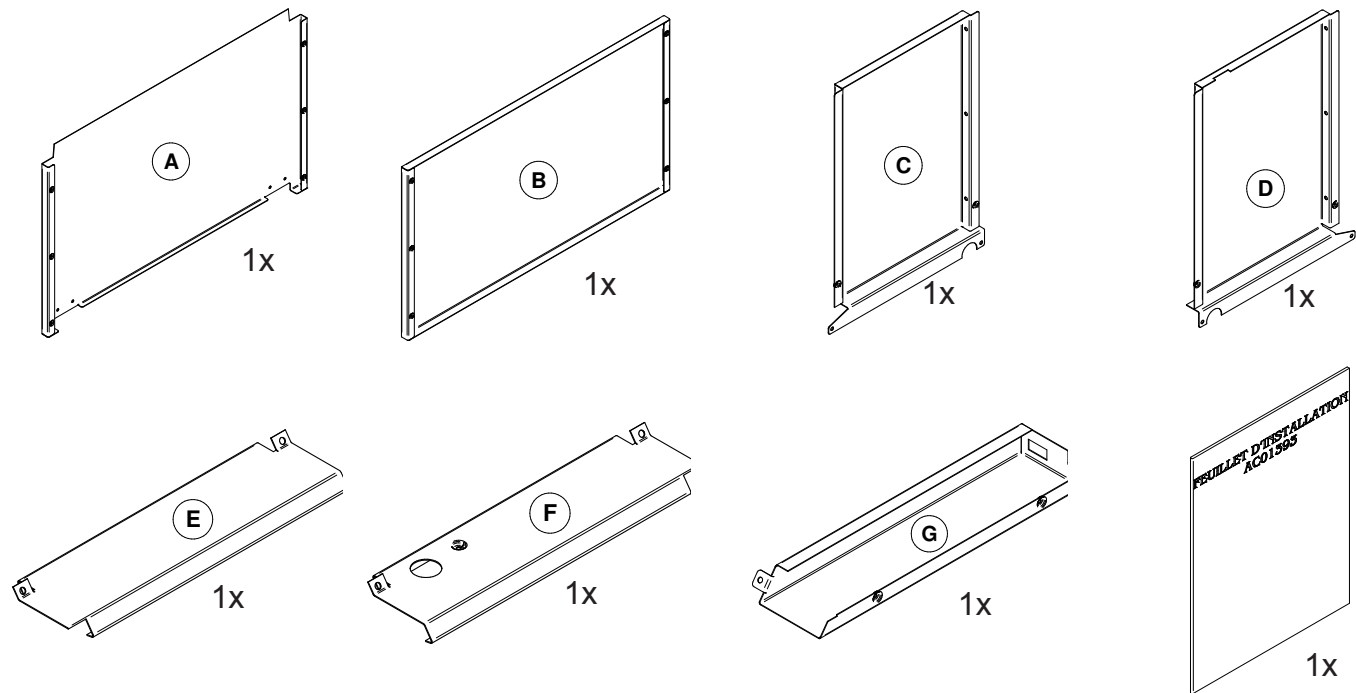

## OUTILS NÉCESSAIRES

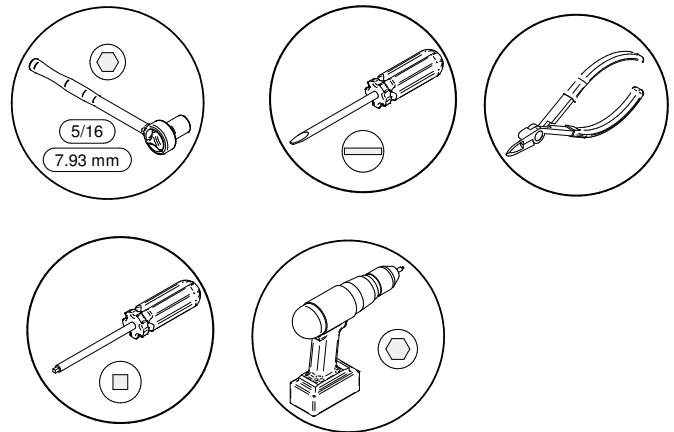

## RECOMMANDATIONS

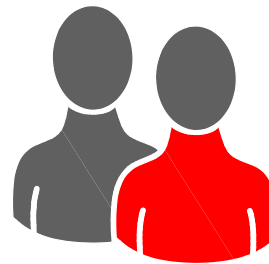

2 PERSONNES

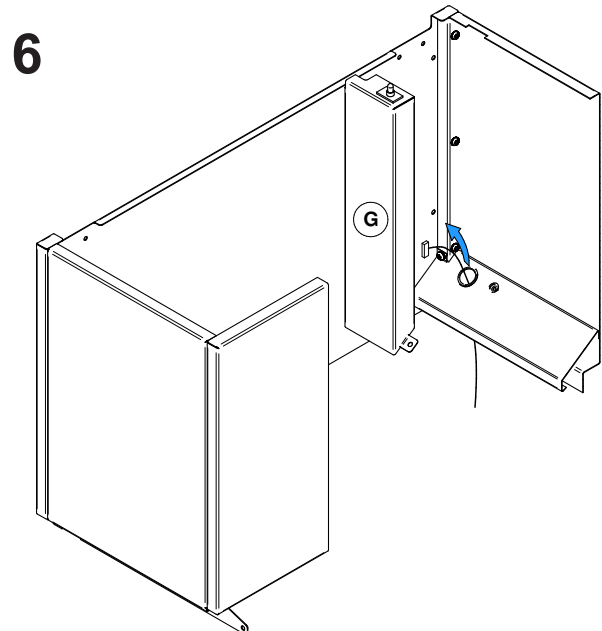
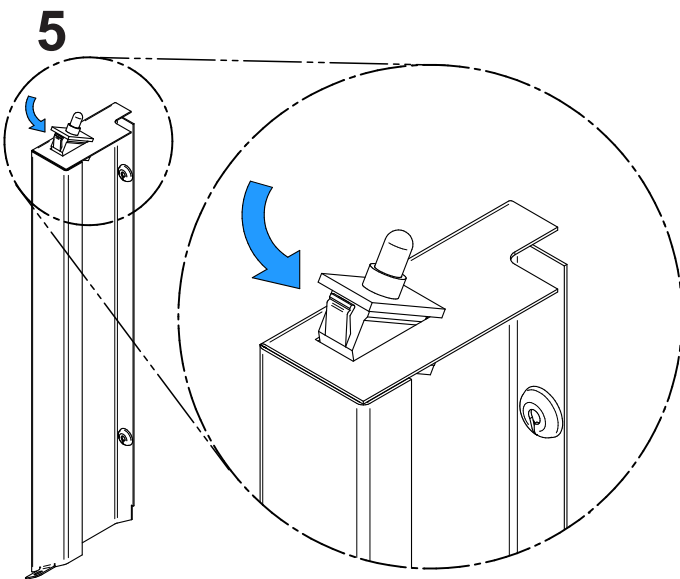
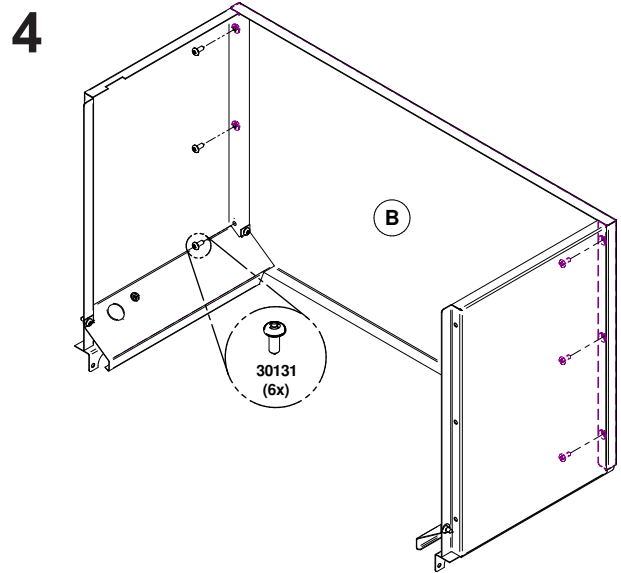
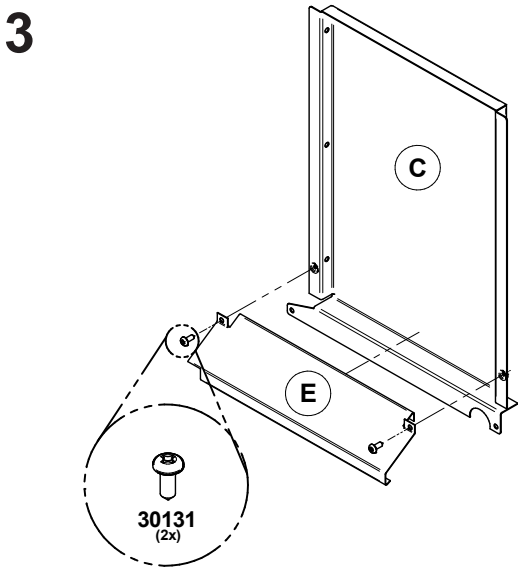
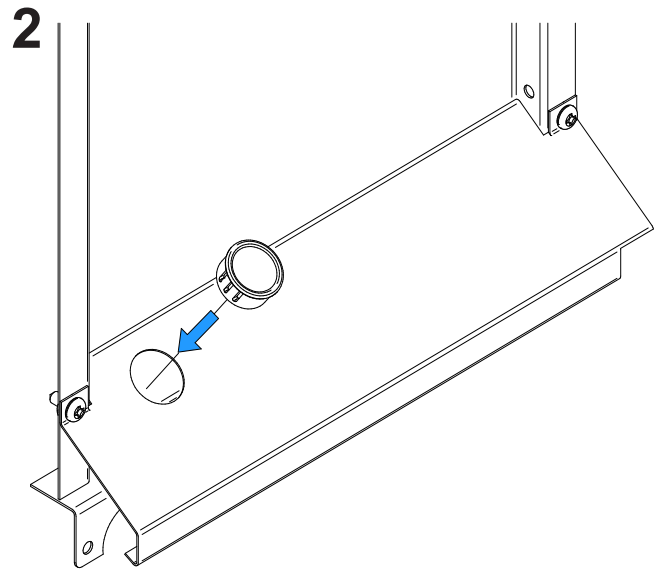
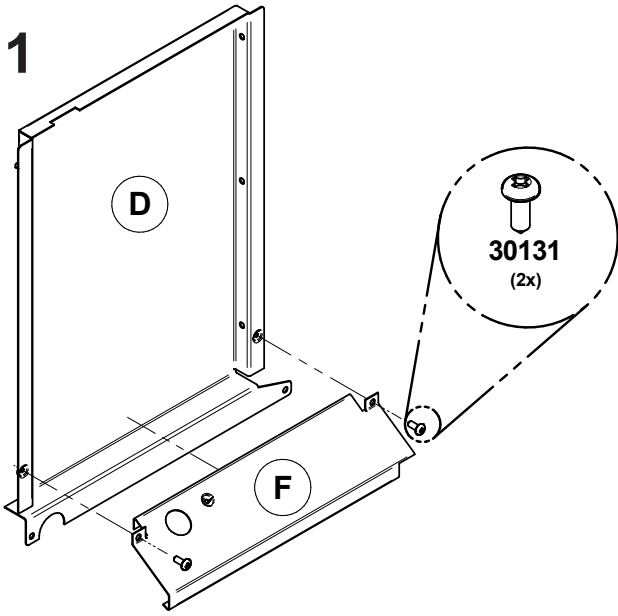

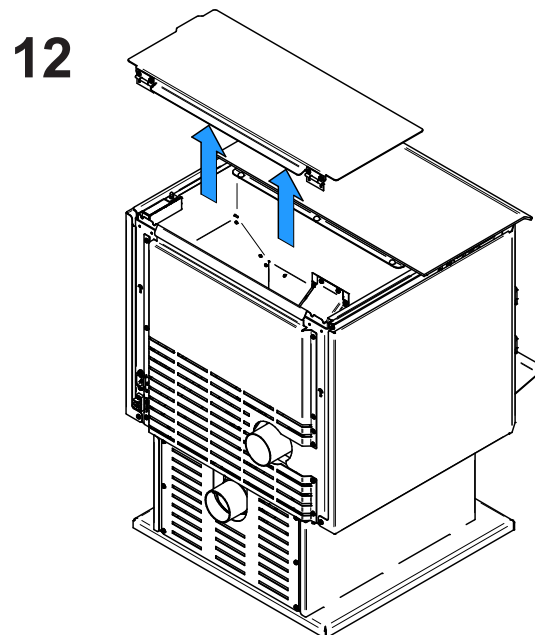
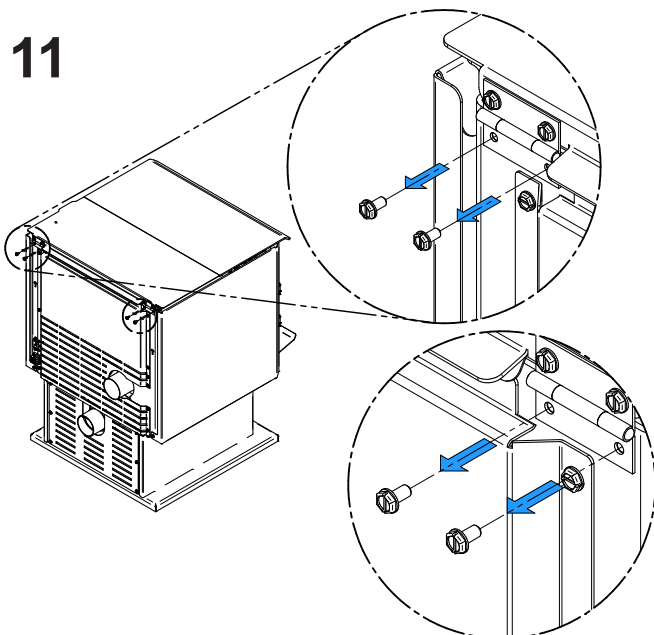
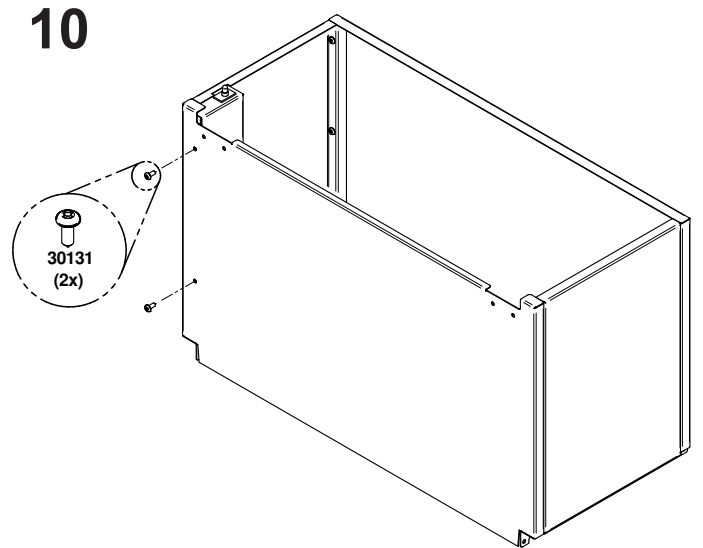
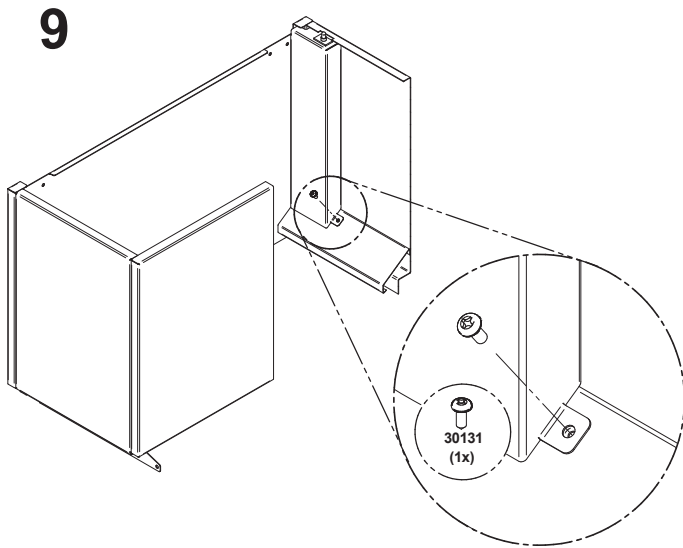
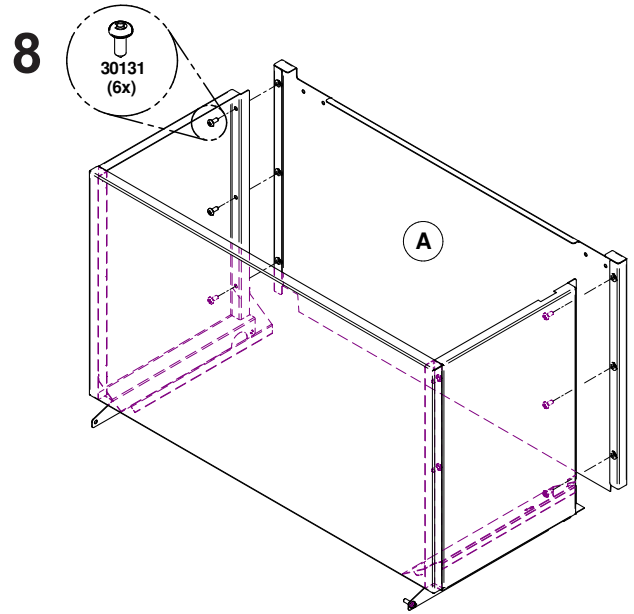
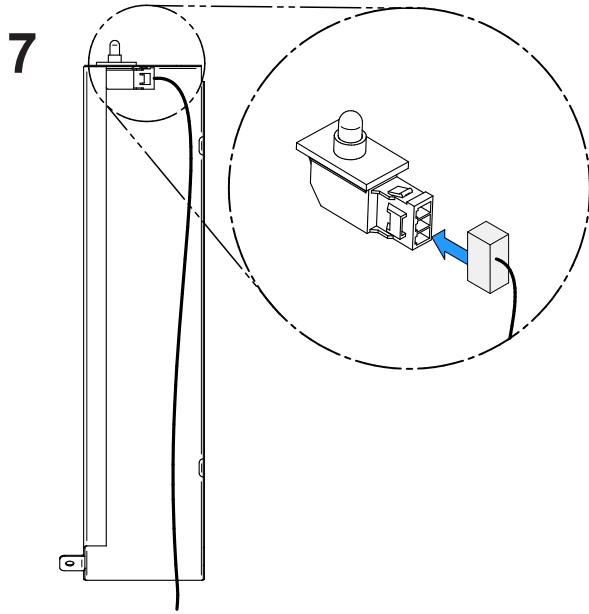

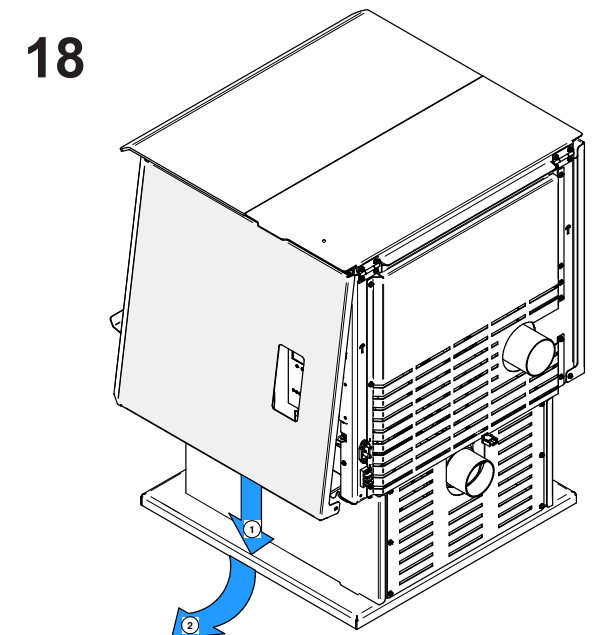
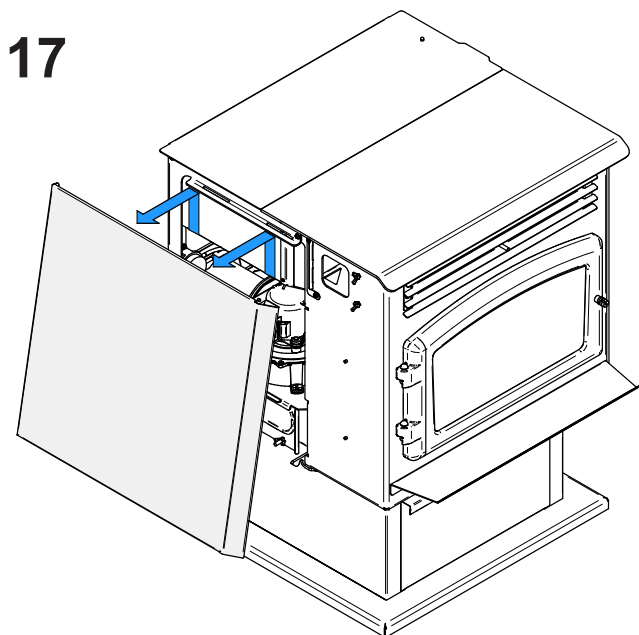
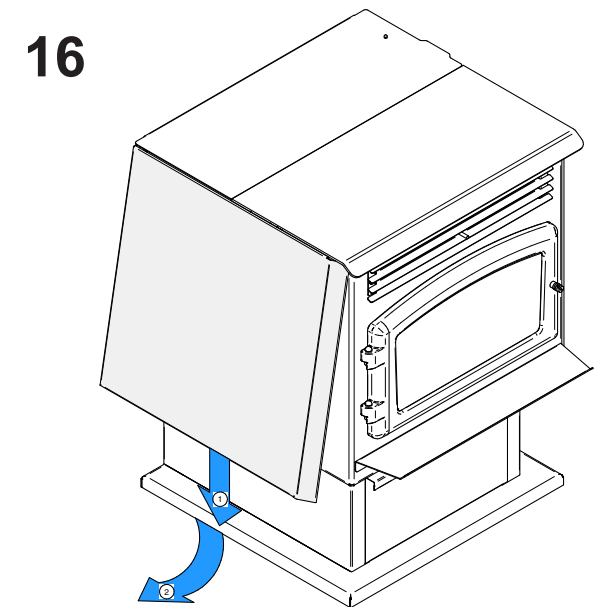
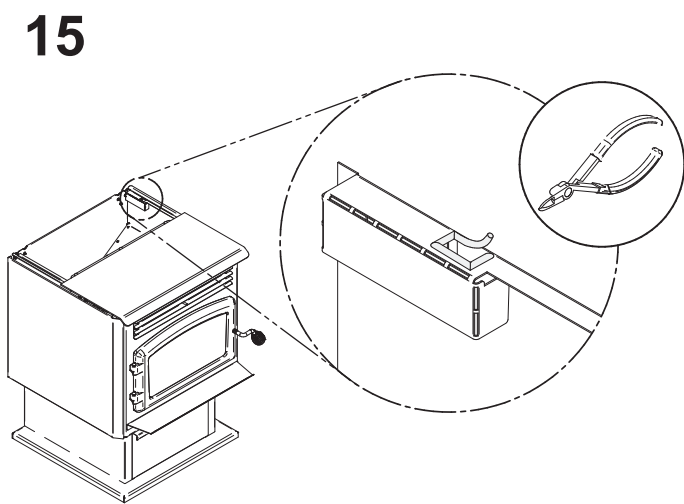
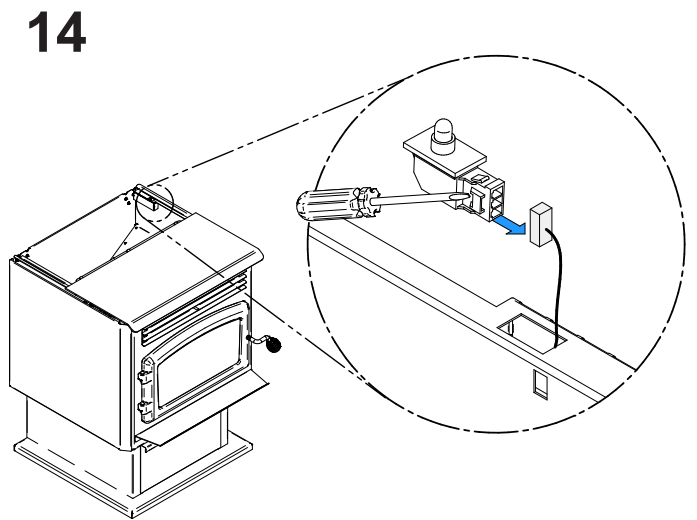
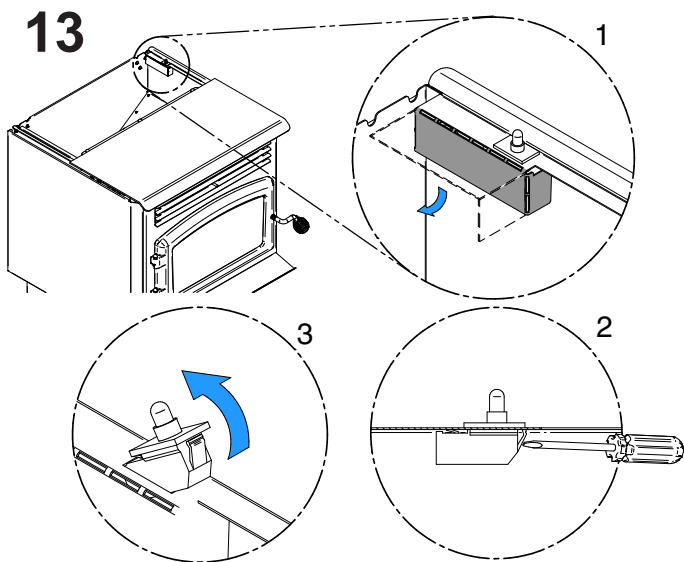

19

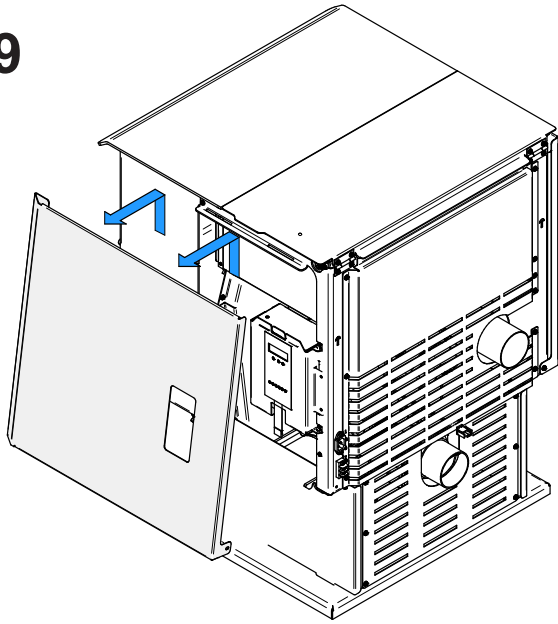

20

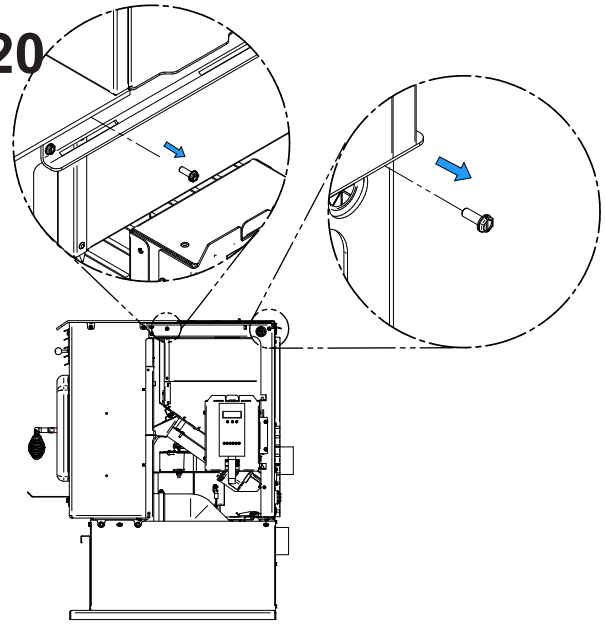

21

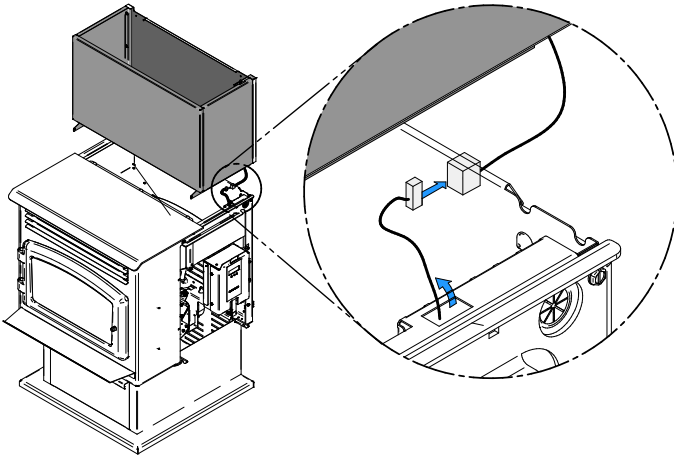

22

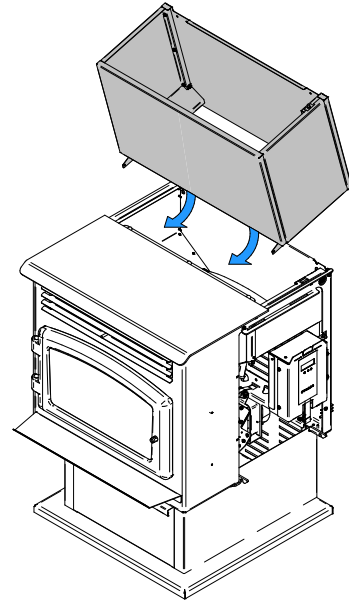

23

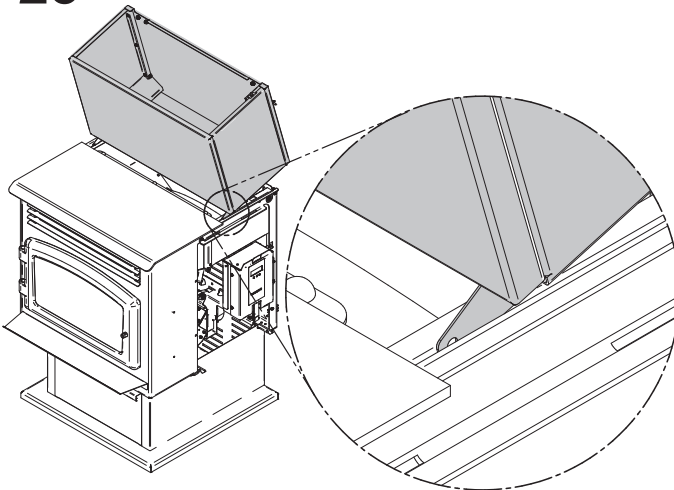

24

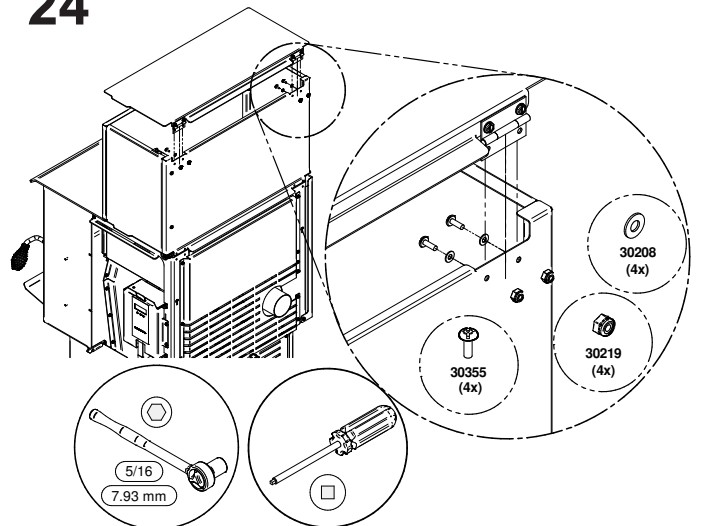

25

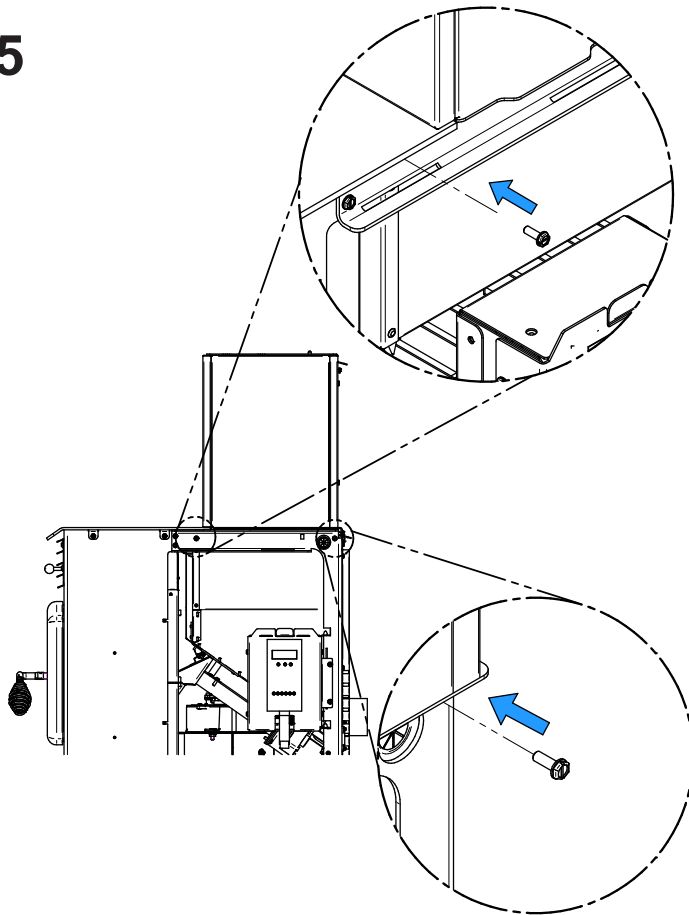

**Fabricant de poêles international inc.**  
250, rue de Copenhague, St-Augustin-de-Desmaures (Québec)  
Canada, G3A 2H3

Service aux consommateurs : 1-877-356-6663  
Courriel : [tech@sbi-international.com](mailto:tech@sbi-international.com)